

GEAUGA COUNTY GEODETIC SURVEY

MONUMENT RECORD

STATION: Mon # 590

TOWNSHIP: Auburn

STATE PLANE COORDINATE SYSTEM:

OHIO NORTH ZONE

HORIZONTAL CONTROL DATA

VERTICAL CONTROL DATA

TYPE: _____

TYPE: _____

ORDER: _____

ORDER: _____

LATITUDE: _____ LONGITUDE: _____

ELEVATION (FEET):

1202.97

Y(NORTH) (FEET): _____ X(EAST) (FEET): _____

ELEVATION (METERS): _____

Y(NORTH) (METERS): _____ X(EAST) (METERS): _____

DESCRIPTION:

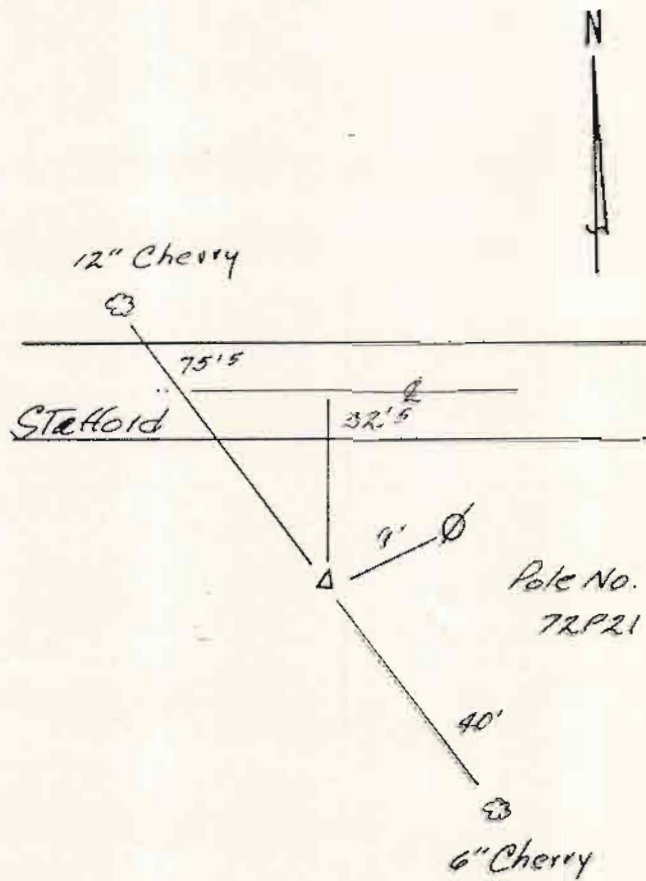
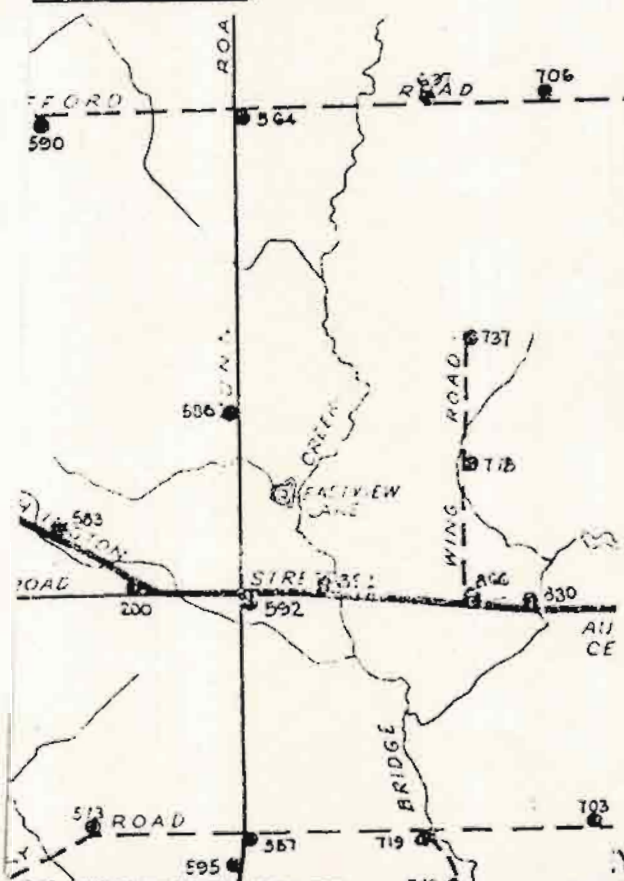

Pole No. 72P21

THEY ARE 2.5" DIAMETER BRASS PLATES SET IN CONCRETE POSTS. THE PLATE READS, GEAUGA COUNTY CONTROL SURVEY. THE MONUMENTS SHOULD ACTUATE MAGNETIC LOCATOR DEVICES.

RECOVERY NOTES: